

MASCHI A MACCHINA - MACHINE TAPS

MASCHI A MACCHINA **HSSE M35 5%Co**

SCANALATURE ELICOIDALI - ELICA DESTRA 15° - Imbocco "C"

Filettatura ASME B1.1 a passo fine UNF - 2B

MACHINE TAPS **HSSE M35 5%Co**

SPIRAL FLUTES - RIGHT HELIX 15° - Chamfer form "C"

ASME B1.1 Unified Fine Thread UNF- 2B

 HSSE

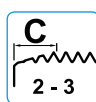
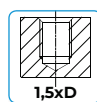
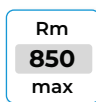
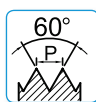

DIN 371 D ≤ 12/28 UNF

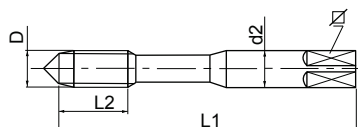

DIN 374 D ≥ 1/4 UNF

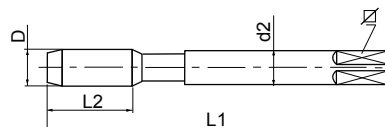

DIN 371 / DIN 374							4574.1	4574.T1
D	filetti x 1" TPI	L ₁	L ₂	d ₂	□		nudi / naked	TIN
n. 6	40	56	11	4,0	3,0	2,95		
n. 8	36	63	13	4,5	3,4	3,50		
n. 10	32	70	13	6,0	4,9	4,10		
n. 12	28	80	16	6,0	4,9	4,60		
1/4	28	80	16	4,5	3,4	5,50		
5/16	24	90	18	6,0	4,9	6,90		
3/8	24	90	20	7,0	5,5	8,50		
7/16	20	100	20	8,0	6,2	9,90		
1/2	20	100	22	9,0	7,0	11,50		
9/16	18	100	22	11,0	9,0	12,90		
5/8	18	100	25	12,0	9,0	14,50		
3/4	16	110	25	14,0	11,0	17,50		
7/8	14	125	25	18,0	14,5	20,40		
1"	12	140	28	18,0	14,5	23,25		

Altre dimensioni su richiesta / Other dimensions on demand

Materiali / Application: nudo / naked: A1 - A2 - A3 - A4 / AM1 - AM2 / R1 - R2

TIN: A1 - A2 - A3 - A4 / G3 - G4 / AM1 - AM2 - AM3 / R1 - R2