

MASCHI A MACCHINA - MACHINE TAPS

MASCHI A MACCHINA **HSS-Co-PM**

SCANALATURE ELICOIDALI - **ELICA SINISTRA 10° - TAGLIO DESTRO** - Imbocco "D"

Filettatura metrica ISO/DIN 13 - UNI 4535 a passo fine - **6HX**

Rivestimento TICN per NICKEL e leghe

MACHINE TAPS **HSS-Co-PM**

SPIRAL FLUTES - LEFT HELIX 10° - RIGHT CUT - Chamfer form "D"

ISO Metric Fine Thread - UNI 4535 - DIN 13 - **6HX**

TICN coated for NICKEL and alloys



HSS-Co-PM



CRESTE ARROTONDATE
WITH ROUNDED CREST

6HX



4521.XN1

4H



4521.XJN1

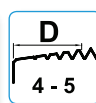
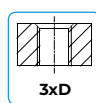
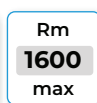
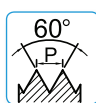

NORMA DI FABBRICA - FIUM NORM

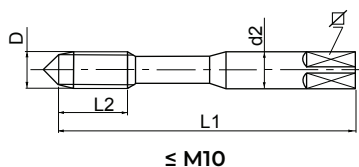

NORMA DI FABBRICA - FIUM NORM

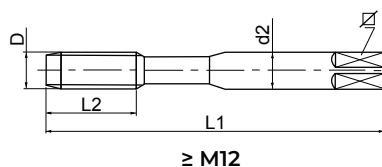

NORMA DI FABBRICA							4521.XN1	4521.XJN1
D	p	L₁	L₂	d₂			6HX	MJ - 4H
8,0	1	90	25	8,0	6,2	7,00		*
10,0	1	100	30	10,0	8,0	9,00		*
10,0	1,25	100	30	10,0	8,0	8,75		*
12,0	1,25	110	30	12,0	9,0	10,75		*
12,0	1,5	110	30	12,0	9,0	10,50		*
14,0	1,5	110	30	12,0	9,0	12,50		*
16,0	1,5	110	30	16,0	12,0	12,50		*

Materiali / Application: A6 / R4 / N2 - N3 / S1 - S3

* Prezzo a richiesta / Price on demand