

MASCHI A MACCHINA - MACHINE TAPS

MASCHI A MACCHINA **HSS-Co-PM**

SCANALATURE ELICOIDALI - ELICA DESTRA 15° - Imbocco "C"

Filettatura metrica ISO/DIN 13 - UNI 4535 a passo grosso - **6HX**

Rivestimento HPC

per materiali ad alta resistenza fino a 45 HRC

MACHINE TAPS **HSS-Co-PM**

SPIRAL FLUTES - RIGHT HELIX 15° - Chamfer form "C"

ISO Metric Coarse Thread - UNI 4535 - DIN 13 - **6HX**

HPC coated

for High Resistance materials until 45 HRC

HSS-Co-PM



4512.X1
4514.X1

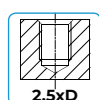

4512.XC1
4514.XC1



DIN 371 D ≤ 10mm.

DIN 376 D ≥ 12mm.

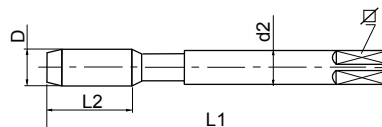
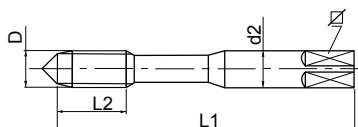

DIN 371 / DIN 376							4512.X1	4514.X1	4512.XC1	4514.XC1
D	p	L ₁	L ₂	d ₂	∠				FORATI WHIT HOLE	FORATI WHIT HOLE
3	0,5	56	5	3,5	2,7	2,50		-	-	-
4	0,7	63	7	4,5	3,4	3,30		-	-	-
5	0,8	70	8	6,0	4,9	4,20		-	-	-
6	1	80	10	6,0	4,9	5,00		-	-	-
8	1,25	90	13	8,0	6,2	6,80		-	-	-
10	1,5	100	15	10,0	8,0	8,50		-	-	-
12	1,75	110	18	9,0	7,0	10,30	-	-	-	-
14	2	110	20	11,0	9,0	12,00	-	-	-	-
16	2	110	20	12,0	9,0	14,00	-	-	-	-

Materiali / Application: A5 - A6 / G3 - G4 / AM4 - AM5 - AM6 / R3

N.B.: ≥ M8 + forati: centro femmina / ≥ M8 with hole: female center